

FLAT FACE QUICK COUPLING ISO 16028 – FEMALE / MALE / SET

Interchangeability	ISO 16028
Shut-off System	Flat Valve
Material	Carbon Steel
Thread Size	BSP (Upon Request: NPT, Metric)
Sealing	Nitrile O-ring (NBR)
Working Temperature	-30 °C and +110 °C
Plating	Zinc Plating (Cr III Passivation)
Heat Treatment	Male nipple
Connection System	Pulling back the sleeve
Disconnection System	Pulling back the sleeve
Connection Under Pressure	Not Allowed
Disconnection Under Pressure	Not Allowed
Upon Request	VITON & High temperature resistant special spring (-30 °C & +225 °C), Polyurethane (PU)
Applications	Construction, production, national defense, aviation, mobile hydraulic, chemical, mining

FLAT FACE QUICK COUPLING - FEMALE – ISO 16028

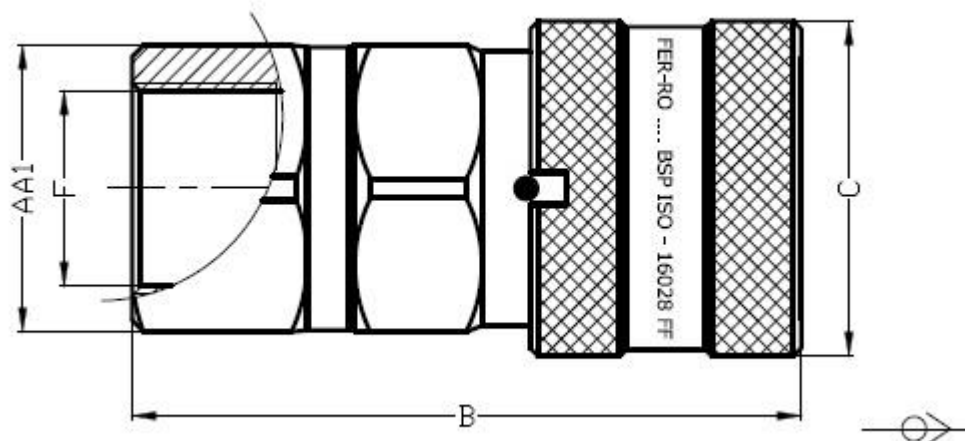

Technical Specifications

Thread Size F	Working Pressure Bar	Dimensions		
		AA1	B	C
1/4" BSP	380	24	63.80	28
3/8" BSP	350	27	78	31
1/2" BSP	350	27	78	32
3/4" BSP	350	36	91	42
1" BSP	330	41	103.60	47.50

FLAT FACE QUICK COUPLING - MALE – ISO 16028

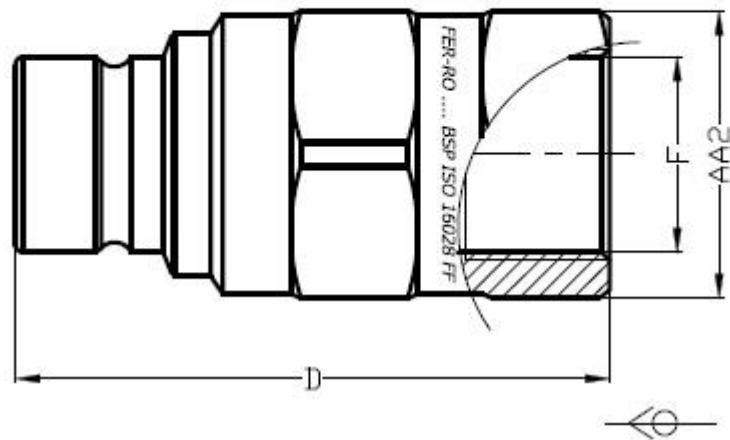

Technical Specifications

Thread Size F	Working Pressure Bar	Dimensions	
		AA2	D
1/4" BSP	380	22	50
3/8" BSP	350	27	66
1/2" BSP	350	27	66
3/4" BSP	350	36	83
1" BSP	330	41	100

FLAT FACE QUICK COUPLING - SET – ISO 16028

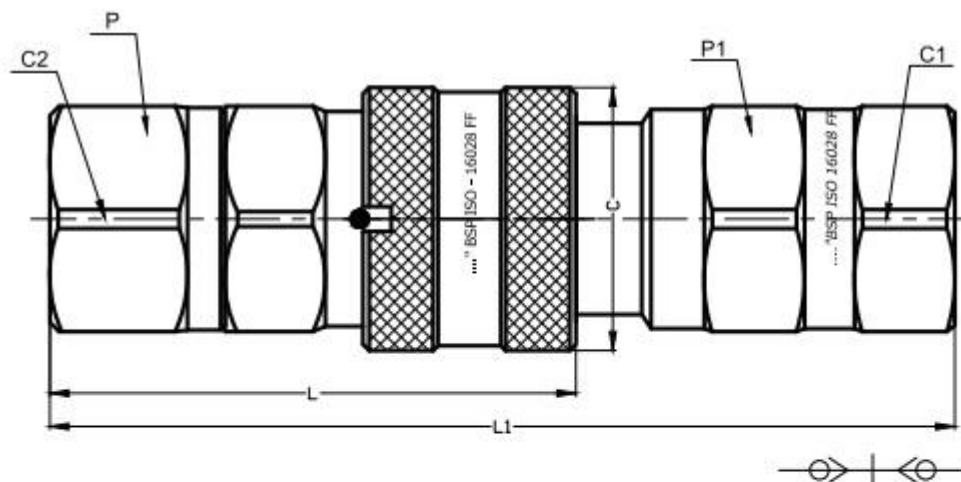

Technical Specifications

Thread Size	Working Pressure Bar	Dimensions - mm							
		C	C1	C2	L	L1	P	P1	
1/4" BSP	380	28	24.50	27	66	99.50	24	22	
3/8" BSP	350	32	30	30	79	125.50	27	27	
1/2" BSP	350	32	30	30	79	125.50	27	27	
3/4" BSP	350	42	40	40	90	151	36	36	
1" BSP	330	47.50	46	46	105.50	179	41	41	